

Right-of-Way Agreement

This Agreement is made and entered into by and between **Derek R. Metcalfe** whose address is **13377 Albion Circle, Thornton, Colorado 80241** ("Owner"), and the County of Adams, State of Colorado, a body politic, who address is 4430 South Adams County Parkway, Brighton, Colorado, 80601 ("County") for the conveyance of rights-of-way on property located at **7701 York Street, Denver, Colorado 80229**, hereinafter (the "Property") for the York Street Improvements Project – York Street from East 78th Avenue to Highway 224 (the "Project"). The legal description and conveyance documents for the interests on said Property are set forth in **Exhibit A** attached hereto and incorporated herein by this reference.

The compensation agreed to by the Owner and the County for the acquisition of the Property interests described herein is **ONE THOUSAND THREE HUNDRED AND NO/100'S DOLLARS (\$1,300.00.00)** including the performance of the terms of this Agreement, the sufficiency of which is hereby acknowledged. This consideration has been agreed upon and between the parties as the total just compensation due to the Owner and the consideration shall be given and accepted in full satisfaction of this Agreement.

In consideration of the above premises and the mutual promise and covenants below, the Owner and the County agree to the following:

1. The Owner hereby warrants that the Owner is the sole Owner of the Property, that the Owner owns the Property in fee simple subject only to matters of record and that the Owner has the power to enter into this Agreement.
2. The Owner agrees to execute and deliver to the County the attached conveyance documents on the property upon tender by the County of a warrant (check) for the compensation agreed upon as soon as possible following the execution of this agreement with an expected date of March 27, 2017.
3. Owner hereby irrevocably grants to the County possession and use of the property interests on the Property upon execution of this Agreement by the Owner and the County. This grant of possession shall remain in effect with respect to the Property until such time as the County obtains from the Owner the attached conveyance documents.
4. The County through its contractor shall assure that reasonable access shall be maintained to the Owner's property at all times for ingress and egress. If necessary, any full closure of access shall be coordinated between the contractor and the Owner and/or its agent.
5. The Owner has entered into this Agreement acknowledging that the County has the power of eminent domain and required the Property for a public purpose.

6. If the Owner fails to consummate this agreement for any reason, except the County's default, the County may at its option, enforce this agreement by bringing an action against the Owner for specific performance.
7. This Agreement contains all agreements, understandings and promises between the Owner and the County, relating to the Project and shall be deemed a contract binding upon the Owner and County and extending to the successors, heirs and assigns.
8. This Agreement has been entered into in the State of Colorado and shall be governed according to the laws thereof.

Owner(s):

By: _____

Printed Name: Derek R. Metcalfe

Title: Owner

Approved:

BOARD OF COUNTY COMMISSIONERS-COUNTY OF ADAMS, STATE OF COLORADO

Chair

Date

Approved as to Form:

County Attorney



Drexel, Barrell & Co.

MAY 2, 2016

Engineers/Surveyors

Boulder
Colorado Springs
Greeley

1800 38th Street
Boulder, CO 80301-2620

303.442.4338
303.442.4373 Fax

LEGAL DESCRIPTION PARCEL 32 RIGHT-OF-WAY DEDICATION

A TRACT OF LAND LOCATED IN THE NE1/4 OF SECTION 35, T2S, R68W OF THE 6TH P.M., COUNTY OF ADAMS, STATE OF COLORADO, BEING MORE PARTICULARLY DESCRIBED AS FOLLOWS:

COMMENCING AT THE E1/4 CORNER OF SAID SECTION 35 AND CONSIDERING THE EAST LINE OF SAID NE1/4 TO BEAR N00°12'30"E, THENCE N04°16'47"W, 766.74 FEET TO THE WESTERLY LINE OF YORK STREET, SAID POINT BEING THE **TRUE POINT OF BEGINNING**;

THENCE S00°12'30"W, 23.54 FEET ALONG SAID WESTERLY LINE TO THE NORTHERLY LINE OF EAST 77TH AVENUE; THENCE S89°44'43"W, 30.65 FEET ALONG SAID NORTHERLY LINE OF EAST 77TH AVENUE THENCE N56°40'07"E, 24.78 FEET; THENCE N44°55'50"E, 14.21 FEET TO THE **TRUE POINT OF BEGINNING**.

CONTAINING 0.007 ACRES OR 325 SQUARE FEET, MORE OR LESS.

LEGAL DESCRIPTION PREPARED BY:
MATHEW E. SELDERS
DREXEL, BARRELL & CO.
1800 38TH STREET
BOULDER, CO 80301
(303) 442-4338

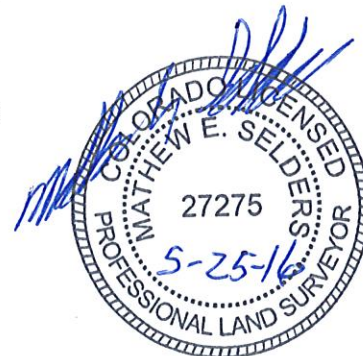

H:\20805-008\TR\SURVEY\DRAWINGS\EXHIBITS\20805-EX01-P32.dwg, 5/5/2016 8:28:39 AM, DWG TO PDF.PC3



NOTES

- IN ACCORDANCE WITH CRS 13-80-105;

NOTICE: ACCORDING TO COLORADO LAW YOU MUST COMMENCE ANY LEGAL ACTION BASED UPON ANY DEFECT IN THIS SURVEY WITHIN THREE YEARS AFTER YOU FIRST DISCOVER SUCH DEFECT. IN NO EVENT, MAY ANY ACTION BASED UPON ANY DEFECT IN THIS SURVEY BE COMMENCED MORE THAN TEN YEARS FROM THE DATE OF THE CERTIFICATION SHOWN HEREON.

Engineers/Surveyors

1600 38TH STREET BOULDER, COLORADO 80301 (303) 442-4338

BOULDER, COLORADO (303) 442-4338

COLORADO SPRINGS, COLORADO (719) 260-0887

GREELEY, COLORADO (970) 351-0645



Revisions - Date	Date 4-21-16	Drawn By JRF	Job No. 20805
	Scale 1"=30'	Checked By MES	Drawing No. IN FILE